

# B3

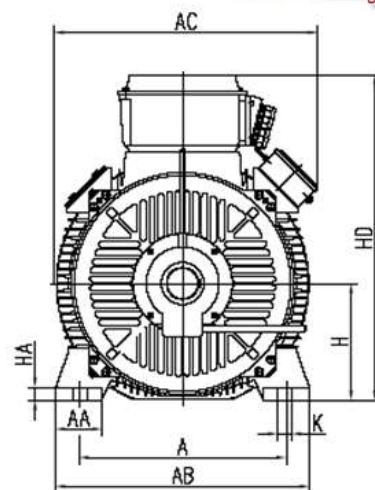
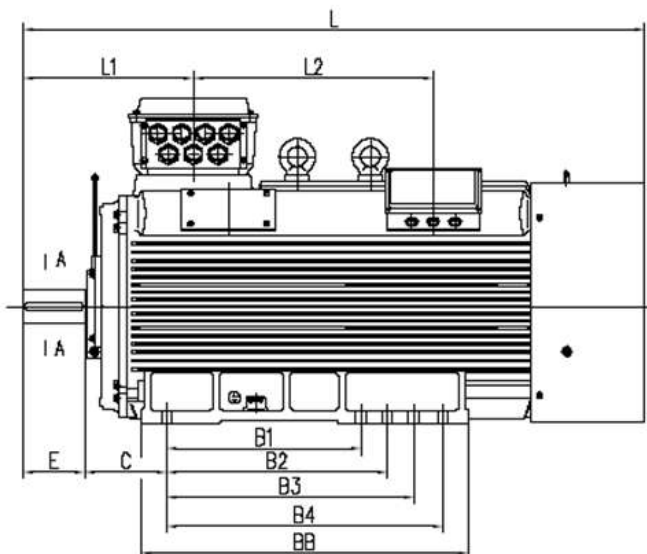

Frame	Pole	MOUNTING												
		A	B1	B2	B3	B4	C	D	E	F	G	H	K	
315X	2	508/560	630	710	800	-	216±4	65 <sup>+0.03</sup> / <sub>+0.01</sub>	140±0.5	18 <sup>0</sup> / <sub>-0.043</sub>	58 <sup>0</sup> / <sub>-0.2</sub>	315 <sup>0</sup> / <sub>-1</sub>	28*54	
315X	4	508/560	630	710	800	-	216±4	80 <sup>+0.03</sup> / <sub>+0.01</sub>	170±0.5	22 <sup>0</sup> / <sub>-0.052</sub>	71 <sup>0</sup> / <sub>-0.2</sub>	315 <sup>0</sup> / <sub>-1</sub>	28*54	
355X	2	630±1.4	630	710	800	-	254±4	75 <sup>+0.03</sup> / <sub>+0.01</sub>	140±0.5	20 <sup>0</sup> / <sub>-0.052</sub>	67,5 <sup>0</sup> / <sub>-0.2</sub>	355 <sup>0</sup> / <sub>-1</sub>	35 <sup>+0.5</sup> / <sub>0</sub>	
355X	4~12	630±1.4	630	710	800	-	254±4	100 <sup>+0.03</sup> / <sub>+0.01</sub>	210±0.5	25 <sup>0</sup> / <sub>-0.052</sub>	86 <sup>0</sup> / <sub>-0.2</sub>	355 <sup>0</sup> / <sub>-1</sub>	35 <sup>+0.5</sup> / <sub>0</sub>	
400X	2	686/710	710	800	900	-	280±4	80 <sup>+0.03</sup> / <sub>+0.01</sub>	170±0.5	22 <sup>0</sup> / <sub>-0.052</sub>	71 <sup>0</sup> / <sub>-0.2</sub>	400 <sup>0</sup> / <sub>-1</sub>	35*47	
400X	4~12	686/710	710	800	900	-	280±4	110 <sup>+0.03</sup> / <sub>+0.01</sub>	210±0.57	28 <sup>0</sup> / <sub>-0.052</sub>	100 <sup>0</sup> / <sub>-0.2</sub>	400 <sup>0</sup> / <sub>-1</sub>	35*47	
450X	2	800±1.75	900	1000	1120	1250	280±4	95 <sup>+0.03</sup> / <sub>+0.01</sub>	170±0.5	25 <sup>0</sup> / <sub>-0.052</sub>	86 <sup>0</sup> / <sub>-0.2</sub>	450 <sup>0</sup> / <sub>-1</sub>	35 <sup>+0.6</sup> / <sub>0</sub>	
450X	4~12	800±1.75	900	1000	1120	1250	280±4	120 <sup>+0.03</sup> / <sub>+0.01</sub>	210±0.57	32 <sup>0</sup> / <sub>-0.062</sub>	109 <sup>0</sup> / <sub>-0.2</sub>	450 <sup>0</sup> / <sub>-1</sub>	35 <sup>+0.6</sup> / <sub>0</sub>	
500X	4~12	900±2.1	1250 ±2.1				315±4	140 <sup>+0.04</sup> / <sub>+0.01</sub>	250±0.57	36 <sup>0</sup> / <sub>-0.062</sub>	128 <sup>0</sup> / <sub>-0.3</sub>	500 <sup>0</sup> / <sub>-1</sub>	42*60	
560X	4~8	1000±2.1	1400 ±2.1				355±4	160 <sup>+0.04</sup> / <sub>+0.01</sub>	300±0.65	40 <sup>0</sup> / <sub>-0.062</sub>	147 <sup>0</sup> / <sub>-0.3</sub>	560 <sup>0</sup> / <sub>-1</sub>	42*52	

Frame	Pole	OUTLINE									
		AC	AA	AB	BB	HA	HD	L1	L2	L	
315X	2	700	120	680	1080	45	845	462	797	1790	
315X	4	700	120	680	1080	45	845	492	797	1820	
355X	2	790	135	760	1140	52	1020	508	841	1880	
355X	4~12	790	135	760	1140	52	1020	538	841	1910	
400X	2	864	160	870	1200	50	1100	512	700	2000	
400X	4~12	864	160	870	1200	50	1100	572	700	2040	
450X	2	1035	225	980	1495	45	1290	570	921	2380	
450X	4~12	1035	225	980	1495	45	1290	610	921	2420	
500X	4~12	1095	180	1080	1600	65	1365	662	980	2560	
560X	4~12	1195	210	1170	1680	76	1480	710	970	2700	

# B3/B5

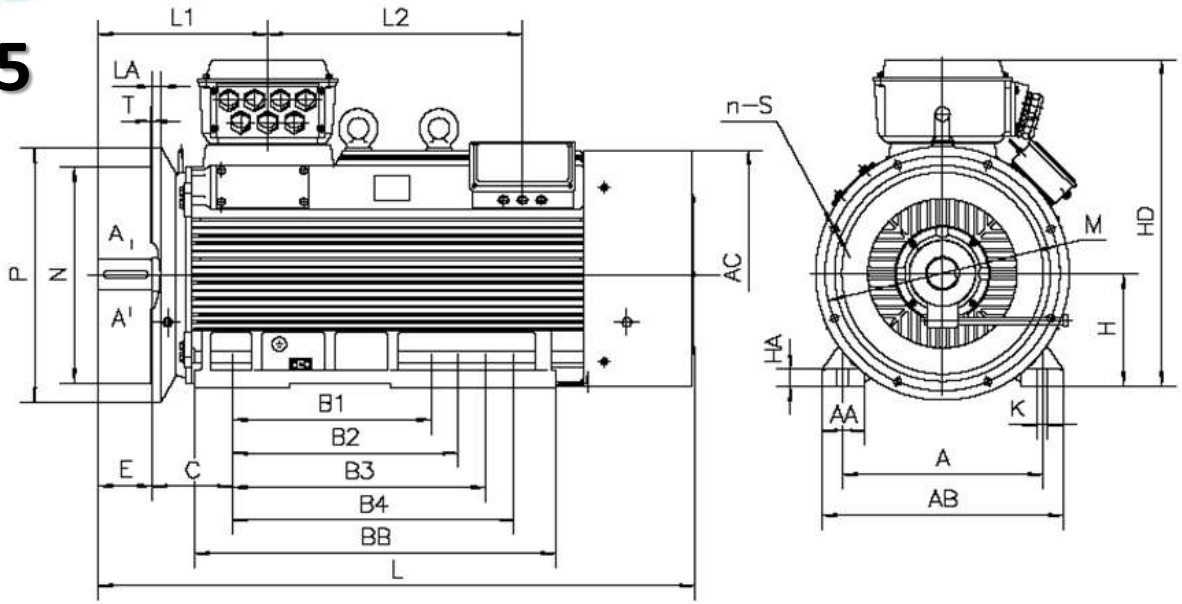

Frame	Pole	MOUNTING											
		A	B1	B2	B3	B4	C	D	E	F	G	H	K
315X	2	508/560	630	710	800	-	216±4	65 <sup>+0.030</sup> <sub>+0.011</sub>	140±0.5	18 <sup>0</sup> <sub>-</sub>	58 <sup>0</sup> <sub>-</sub>	315 <sup>0</sup> <sub>-1</sub>	28*54
315X	4	508/560	630	710	800	-	216±4	80 <sup>+0.030</sup> <sub>+0.011</sub>	170±0.5	22 <sup>0</sup> <sub>-</sub>	71 <sup>0</sup> <sub>-</sub>	315 <sup>0</sup> <sub>-1</sub>	28*54
355X	2	630±1.4	630	710	800	-	254±4	75 <sup>+0.030</sup> <sub>+0.011</sub>	140±0.5	20 <sup>0</sup> <sub>-</sub>	67,5 <sup>0</sup> <sub>-</sub>	355 <sup>0</sup> <sub>-1</sub>	35 <sup>+0.5</sup> <sub>0</sub>
355X	4~12	630±1.4	630	710	800	-	254±4	100 <sup>+0.035</sup> <sub>+0.013</sub>	210±0.5	25 <sup>0</sup> <sub>-</sub>	86 <sup>0</sup> <sub>-</sub>	355 <sup>0</sup> <sub>-1</sub>	35 <sup>+0.5</sup> <sub>0</sub>
400X	2	686/710	710	800	900	-	280±4	80 <sup>+0.030</sup> <sub>+0.011</sub>	170±0.5	22 <sup>0</sup> <sub>-</sub>	71 <sup>0</sup> <sub>-</sub>	400 <sup>0</sup> <sub>-1</sub>	35*47
400X	4~12	686/710	710	800	900	-	280±4	110 <sup>+0.035</sup> <sub>+0.013</sub>	210±0.57	28 <sup>0</sup> <sub>-</sub>	100 <sup>0</sup> <sub>-</sub>	400 <sup>0</sup> <sub>-1</sub>	35*47
450X	2	800±1.75	900	1000	1120	1250	280±4	95 <sup>+0.035</sup> <sub>+0.013</sub>	170±0.5	25 <sup>0</sup> <sub>-</sub>	86 <sup>0</sup> <sub>-</sub>	450 <sup>0</sup> <sub>-1</sub>	35 <sup>+0.6</sup> <sub>0</sub>
450X	4~12	800±1.75	900	1000	1120	1250	280±4	120 <sup>+0.035</sup> <sub>+0.013</sub>	210±0.57	32 <sup>0</sup> <sub>-</sub>	109 <sup>0</sup> <sub>-</sub>	450 <sup>0</sup> <sub>-1</sub>	35 <sup>+0.6</sup> <sub>0</sub>
500X	4~12	900±2.1	1250±2.1				315±4	140 <sup>+0.04</sup> <sub>+0.015</sub>	250±0.57	36 <sup>0</sup> <sub>-</sub>	128 <sup>0</sup> <sub>-</sub>	500 <sup>0</sup> <sub>-1</sub>	42*60
560X	4~8	1000±2.1	1400±2.1				355±4	160 <sup>+0.04</sup> <sub>+0.015</sub>	300±0.65	40 <sup>0</sup> <sub>-</sub>	147 <sup>0</sup> <sub>-</sub>	560 <sup>0</sup> <sub>-1</sub>	42*52

Frame	Pole	OUTLINE						OUTLINE								
		M	N	P	S	T	LA	AA	AB	AC	BB	HA	HD	L1	L2	L
315X	2	600	550	660	8-24	6	22	120	680	700	1080	45	845	462	797	1790
315X	4	600	550	660	8-24	6	22	120	680	700	1080	45	845	492	797	1820
355X	2	740	680	800	8-24	6	25	135	760	790	1140	52	1020	508	841	1880
355X	4~12	740	680	800	8-24	6	25	135	760	790	1140	52	1020	538	841	1910
400X	2	940	880	1000	8-28	6	28	160	870	864	1200	50	1100	512	700	2000
400X	4~12	940	880	1000	8-28	6	28	160	870	864	1200	50	1100	572	700	2040
450X	2	1080	1000	1150	8-28	6	30	225	980	1035	1495	45	1290	570	921	2380
450X	4~12	1080	1000	1150	8-28	6	30	225	980	1035	1495	45	1290	610	921	2420
500X	4~12	1180	1120	1250	8-28	7	32	180	1080	1095	1600	65	1365	662	980	2560
560X	4~12	1180	1120	1250	8-28	7	32	210	1170	1195	1680	76	1480	710	970	2700

# V1

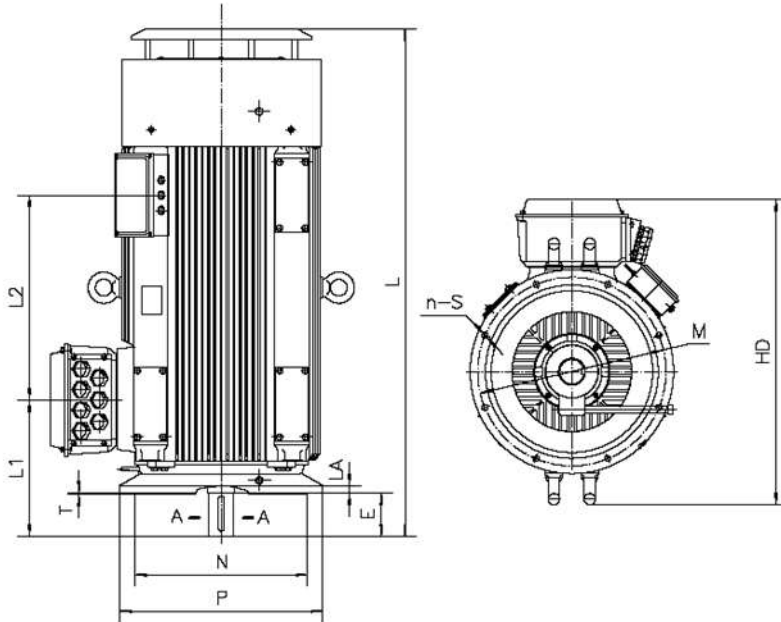

Frame	Pole	MOUNTING																
		D	E	F	G	M	N	P	n-S	T	LA	HD	L1	L2	L			
315X	4	80	+0.03 +0.01	170	22	0 -	71	0 -	600	550	660	8-24	6	22	990	492	797	2020
355X	4~12	100	+0.03 +0.01	210	25	0 -	86	0 -	740	680	800	8-24	6	25	1190	538	841	2250
400X	4~12	110	+0.03 +0.01	210	28	0 -	100	0 -	940	880	1000	8-28	6	28	1270	572	700	2380
450X	4~12	120	+0.03 +0.01	210	32	0 -	109	0 -	1080	1000	1150	8-28	6	30	1520	610	921	2600
500X	4~12	140	+0.04 +0.01	250	36	0 -	128	0 -	1180	1120	1250	8-28	7	32	1576	662	980	2720
560X	4~12	160	+0.04 +0.01	300	40	0 -	147	0 -	1180	1120	1250	8-28	7	32	1681	710	970	2980

## Bearings (IMB3)

Frame	Pole	D.E.	N.D.E.
315 X	2	6317C3	6317C3
315 X	4,6,8	6319C3	6319C3
355 X	2	6318C3	6318C3
355 X	4,6,8	6322C3	6322C3
400 X	2	6220C3	6220C3
400 X	4,6,8	6326C3	6326C3
450 X	2	6221C3	6221C3
450 X	4,6,8	6328C3	6328C3
500 X	2	on demand	on demand
500 X	4,6,8	6330C3	6330C3
560 X	2	on demand	on demand
560 X	4,6,8	6334C3	6330C3